



Google Home Voice Control Setup

## Table of Contents

1 Binding Gateway to Luffa Console

2 How to Setup Google Home Android and iOS

**IMPORTANT BEFORE YOU START, YOU NEED A WORKING GATEWAY, A GMAIL ACCOUNT, AND A SMARTPHONE. FOR GOOGLE HOME IT'S BEST TO ALSO HAVE GOOGLE HOME SPEAKER BUT IT WILL ALSO WORK WITHOUT IT. ONLY GMAIL ACCOUNTS WORK NO OTHERS!**

**MAKE SURE ALL DEVICES HAVE BEEN SETUP AND ARE WORKING BEFORE YOU START THE VOICE SETUP.**

**Note Only Switch and Dimmer products are supported on Google Smart Home action.**

## 1 Binding the Gateway.

Make sure you Gateway has been setup correctly and is working. The white led should be burning on top the Gateway and the Time must be correctly setup in the Gateway.

- 1 Run the AirLive SmartLife Plus APP
- 2 Go to Settings
- 3 Go to Other Settings
- 4 Click Connect to Cloud
- 5 Checkmark "I agree" and click OK
- 6 Click Auth Code
- 7 Copy the Auth code within 60 secs (to be used on the next page)

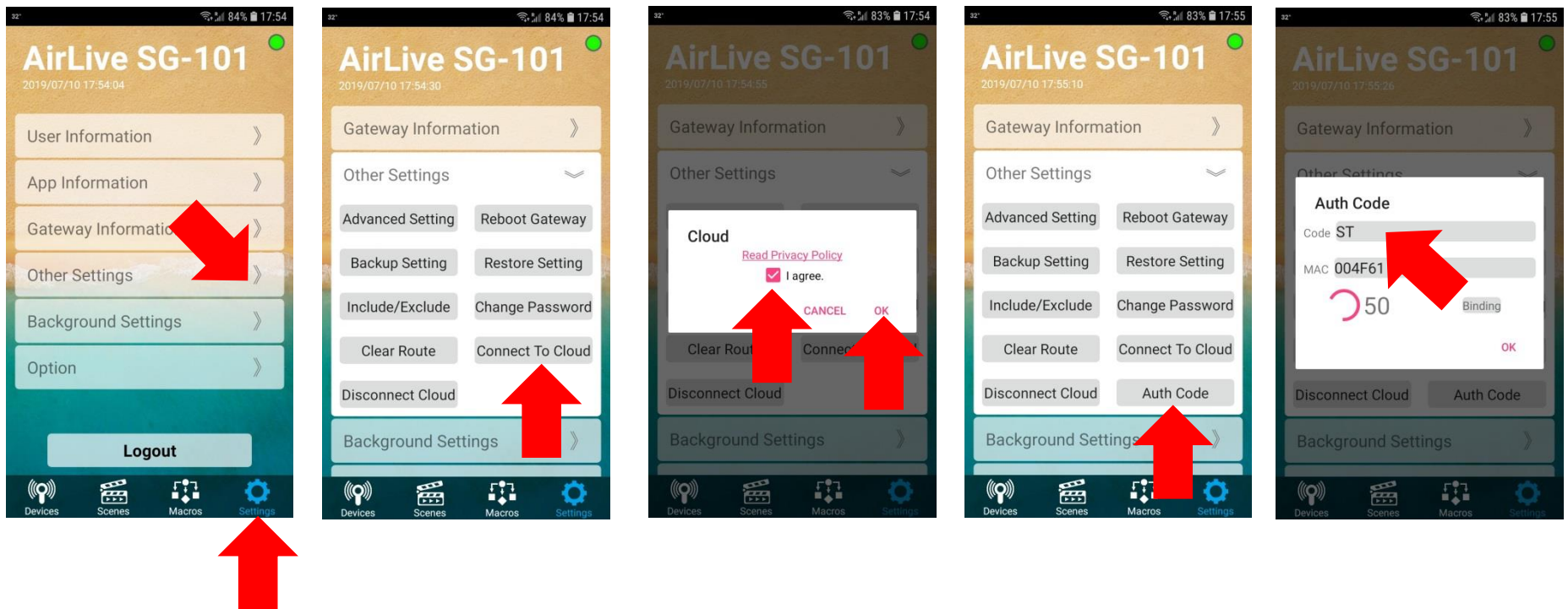

Now open a browser on your computer and Go to the following website <https://console.luffanet.com.tw/#/>

1.1 Click the Login button to register. Note this MUST be a Gmail email address this SAME email address will also need to be used on your phone to make Google Home and Google Assistant work!!

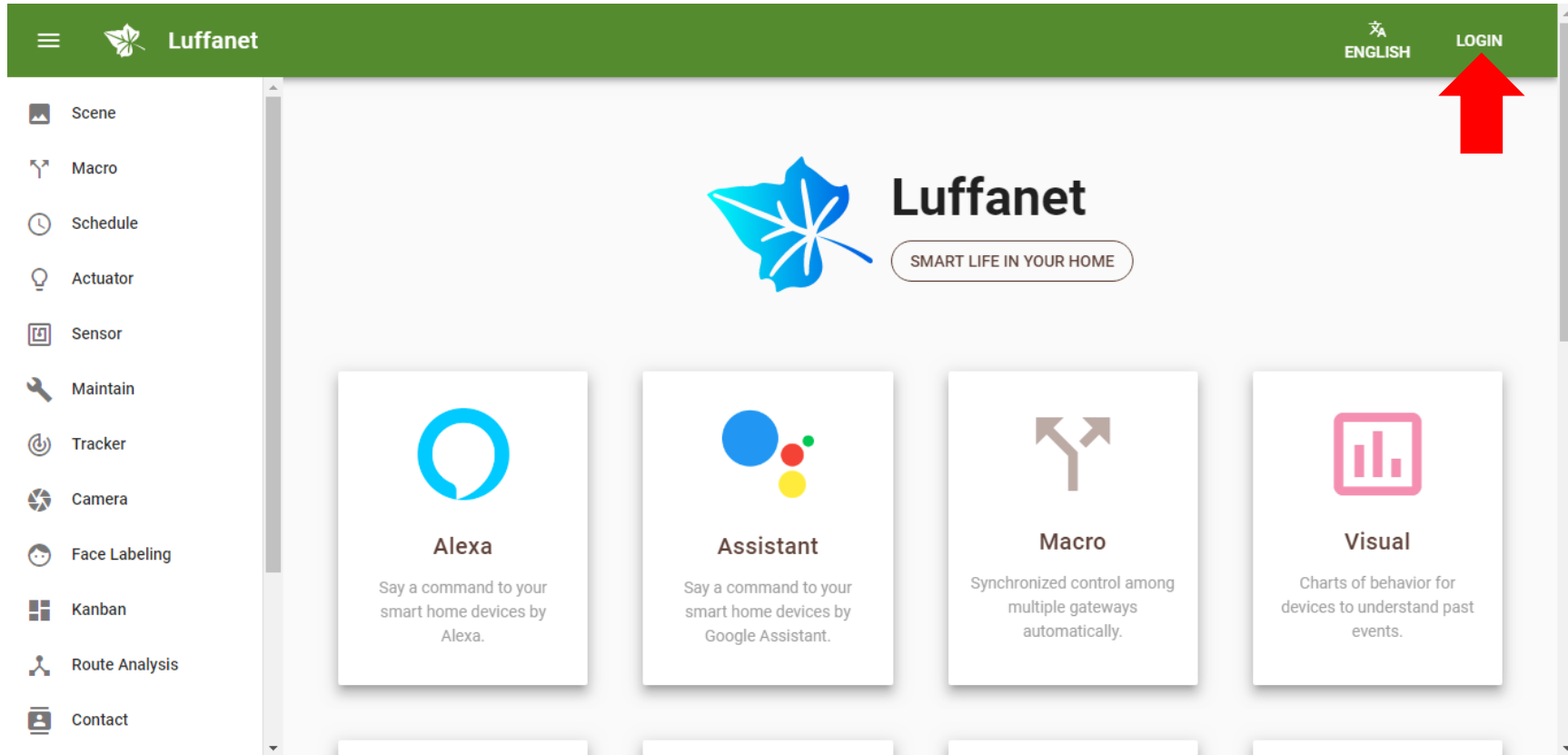

1.2. Select your email address or type in a new one. Again make sure your use the same Email address for the entire setup.

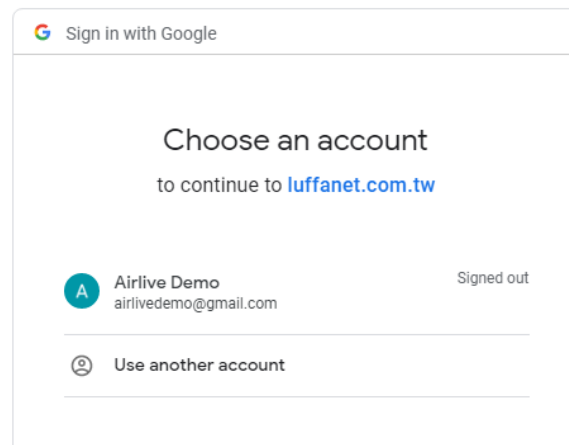

Once this is done you can start to add the Gateway to the Cloud.

### 1.3 Adding the Gateway to the Cloud using the Auth Code.

On the left handside click on Gateway in the new window which now opens click on the + to add the Gateway.

1 Click on Gateway

2 Click on the + symbol

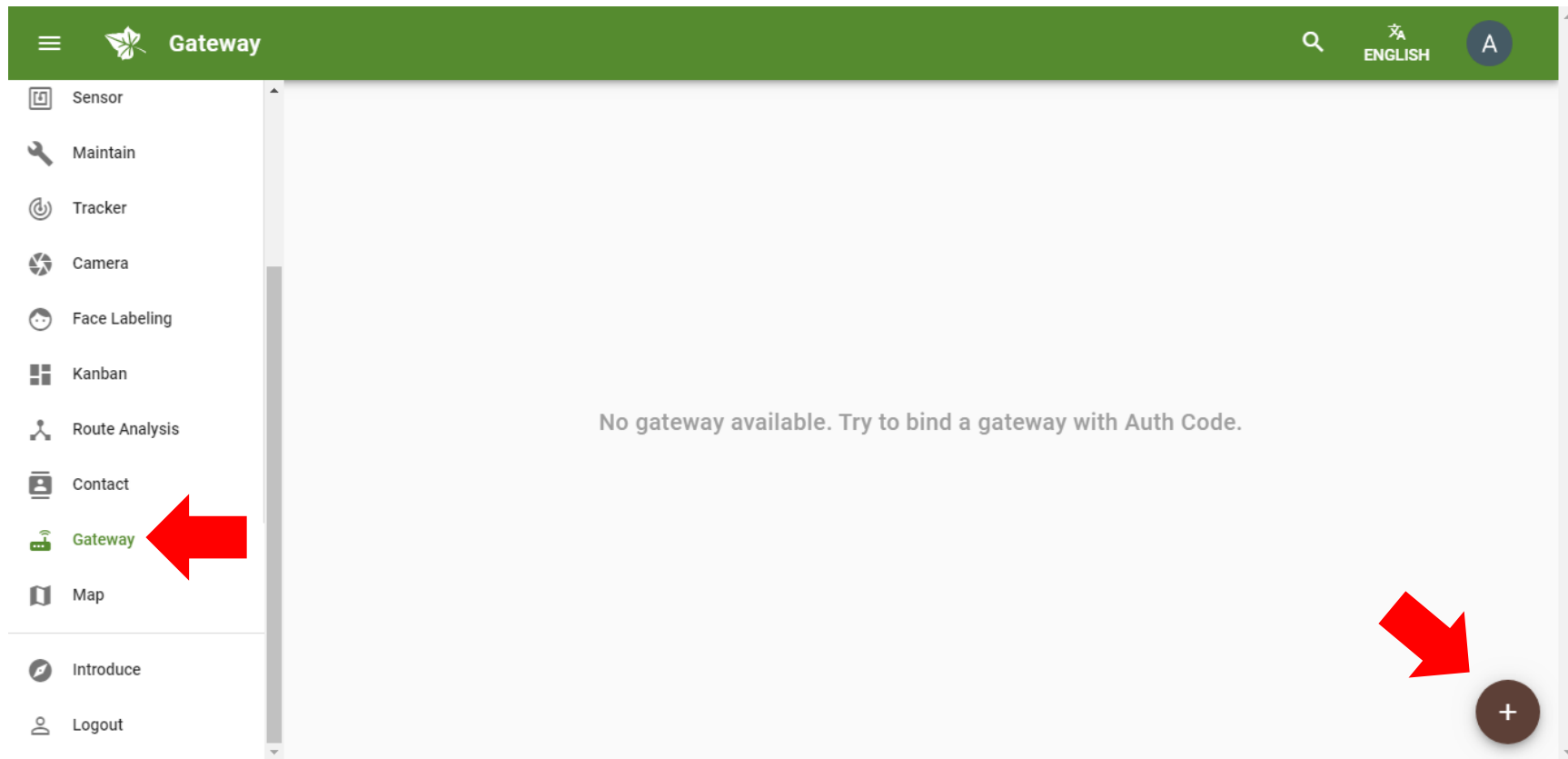

#### 1.4 Enter the Auth code which you got from the APP and Click Add

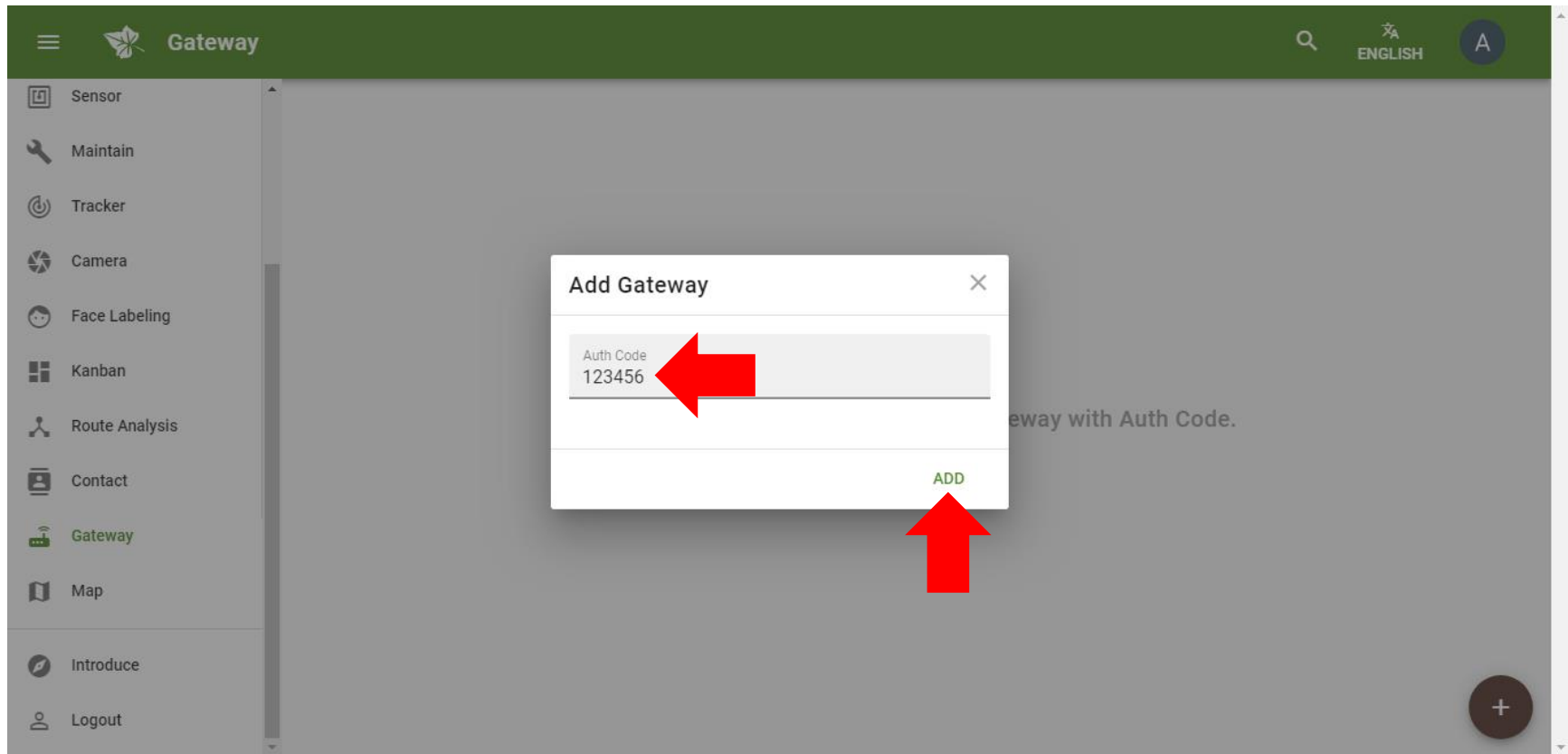

When I type the Auth Code on the Luffa Console Website it Show "Invalid"

1. Check your gateway if it is connected to the internet. (White light on the back of gateway should be on.)
2. Check the time of the gateway if it is correct
3. Disconnect the cloud and connect to the cloud before getting Authcode, After 5 mins then try again.

1.5 Your Gateway has now been added, and your devices will also show. In this example it will show Actuators which are connected.

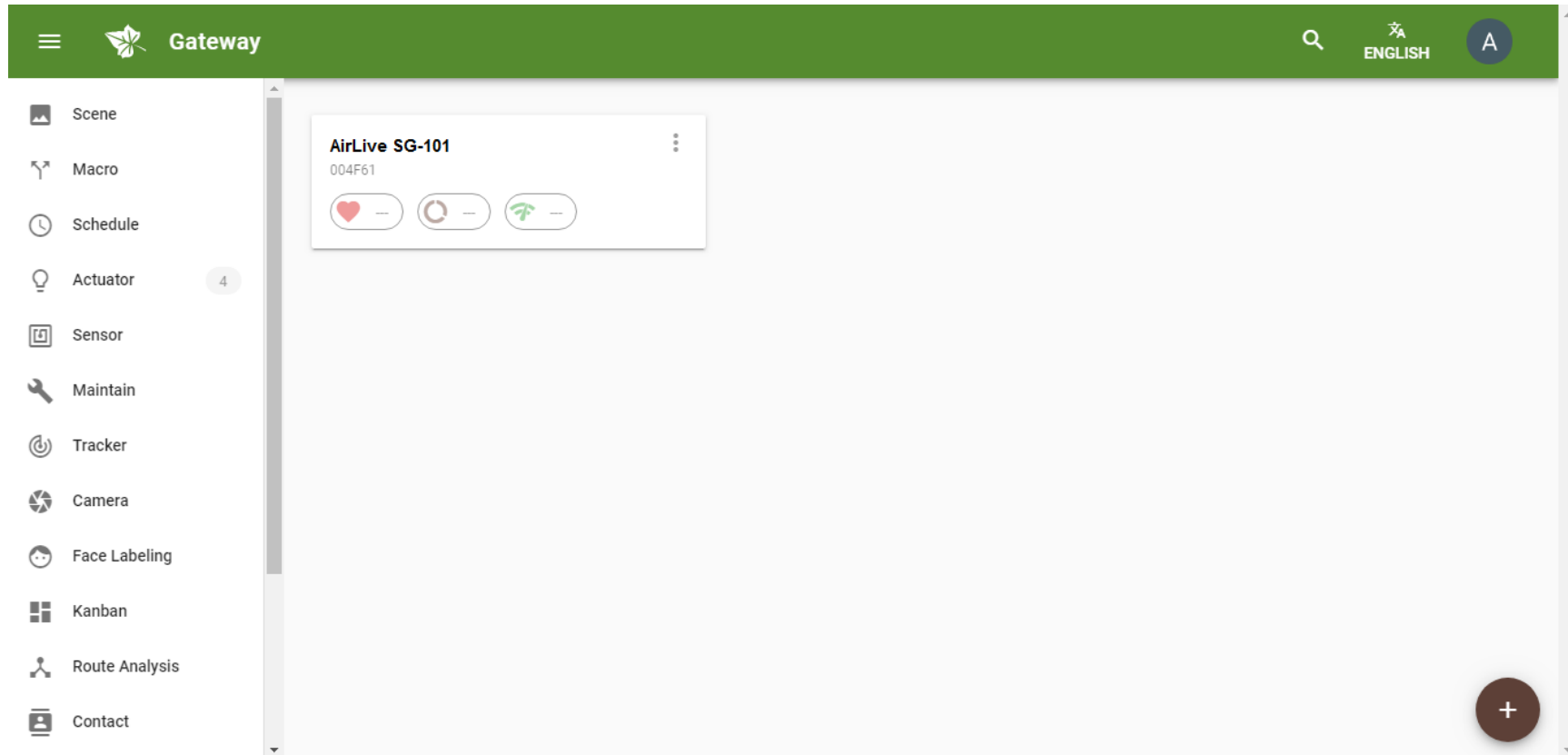

You are now ready to setup the Voice Control.



## 2. How to Setup Google Home for Android and iOS.

To use Google Home please install the Google Home APP and when you have make sure your Google Home Speaker is also working. You must login to the Google Home APP using the same account you used when setting up Luffa Console!

- 1 Start Google Home app (use the same account as use in Luffa Console)
- 2 Click Add
- 3 Setup device
- 4 Click Works with Google (Have something already set up?)

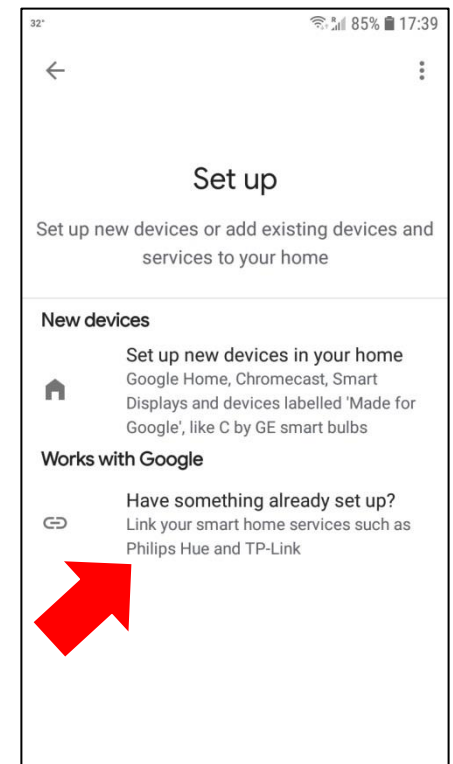
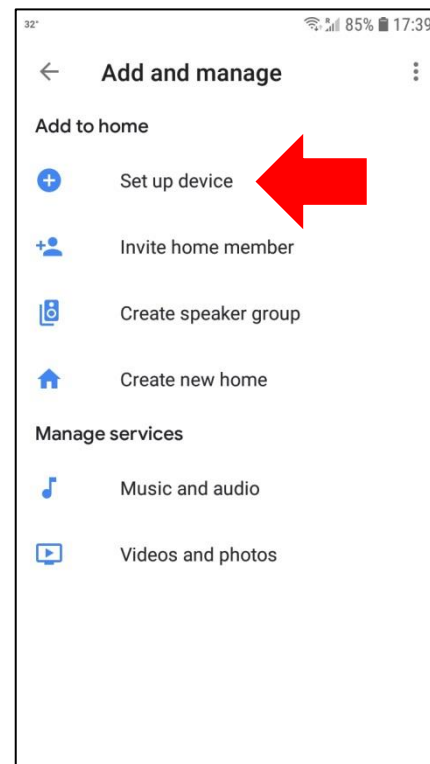
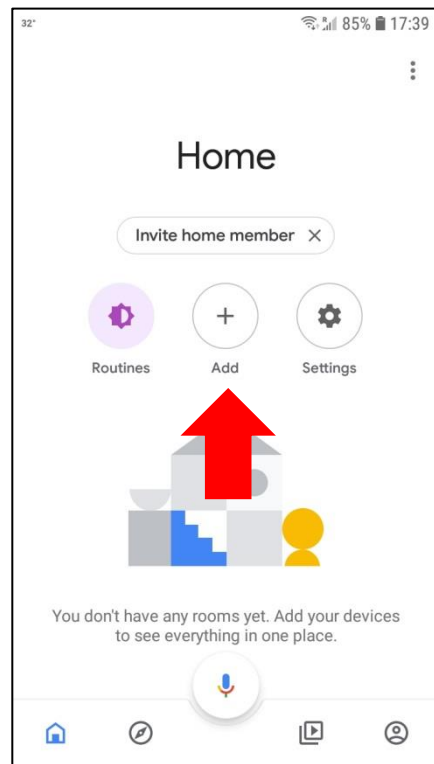
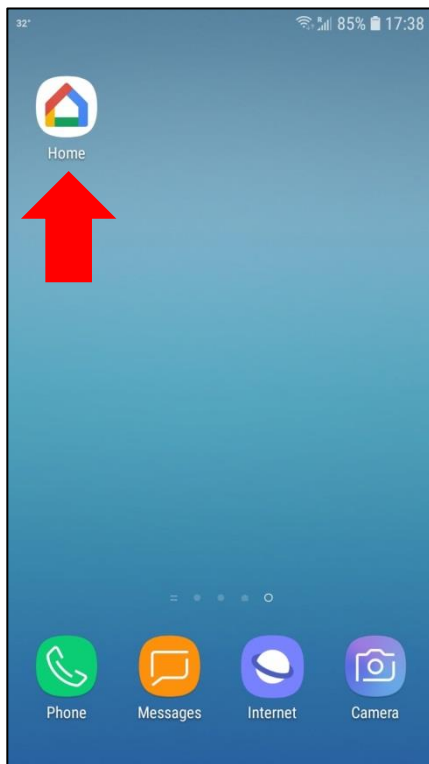

A new window will now open and continue with the following steps.

5 A new window will open with different brand names

6 Type in the search Luffa and Click on Luffanet Console

7 Sign In

8 Select the account you want use. MUST be the same as the one used for Luffa Console

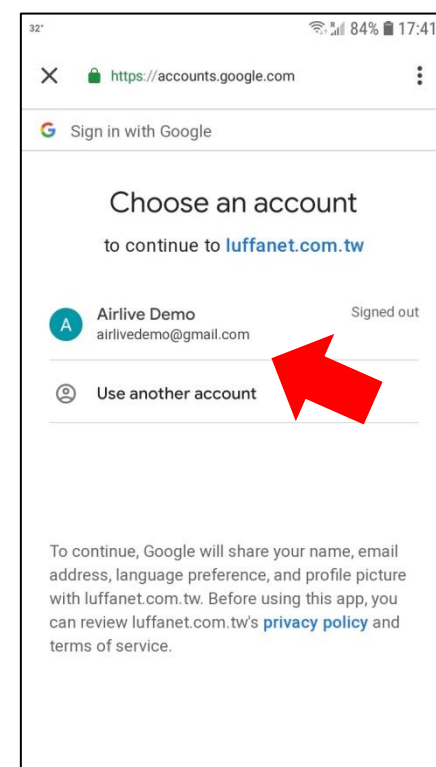
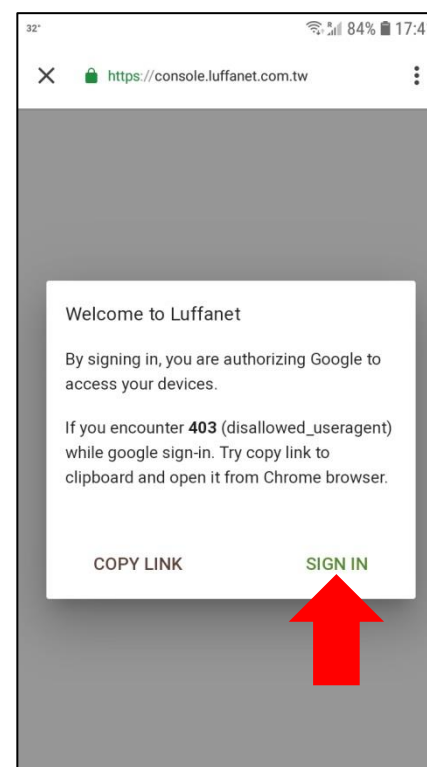
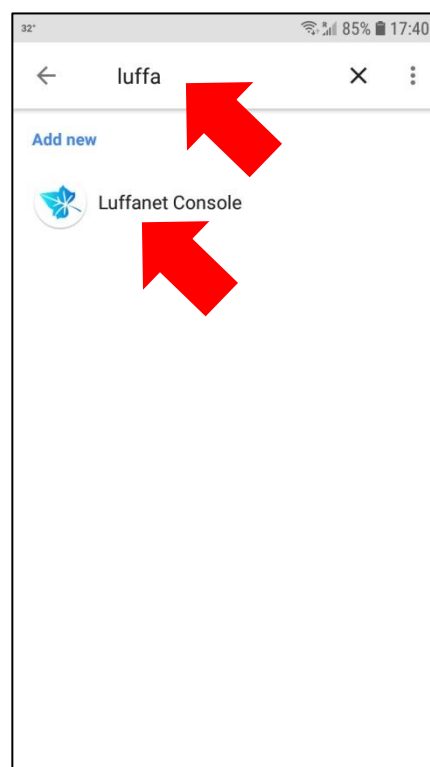
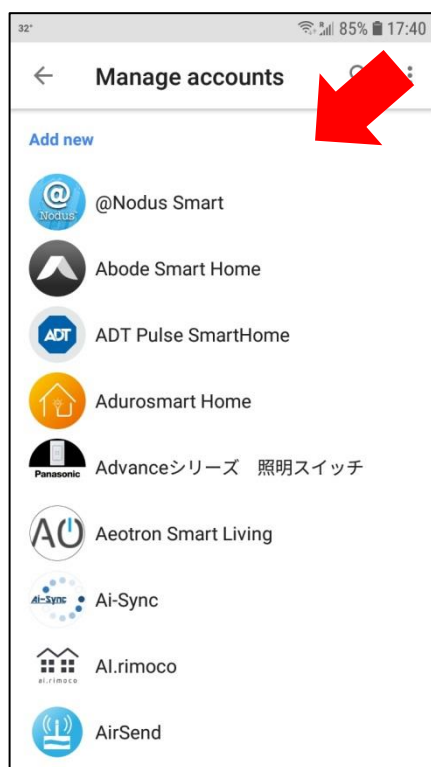

You now need to Join and your devices will be shown in the Google Home.

9 Click Join

10 Your added devices are shown (add to Google Rooms) or directly click “Done”

11 Luffa Console will show your Connected devices (only Switches and Dimmer) Click < to go back

12 Click Left Pointing Arrow < button to go back

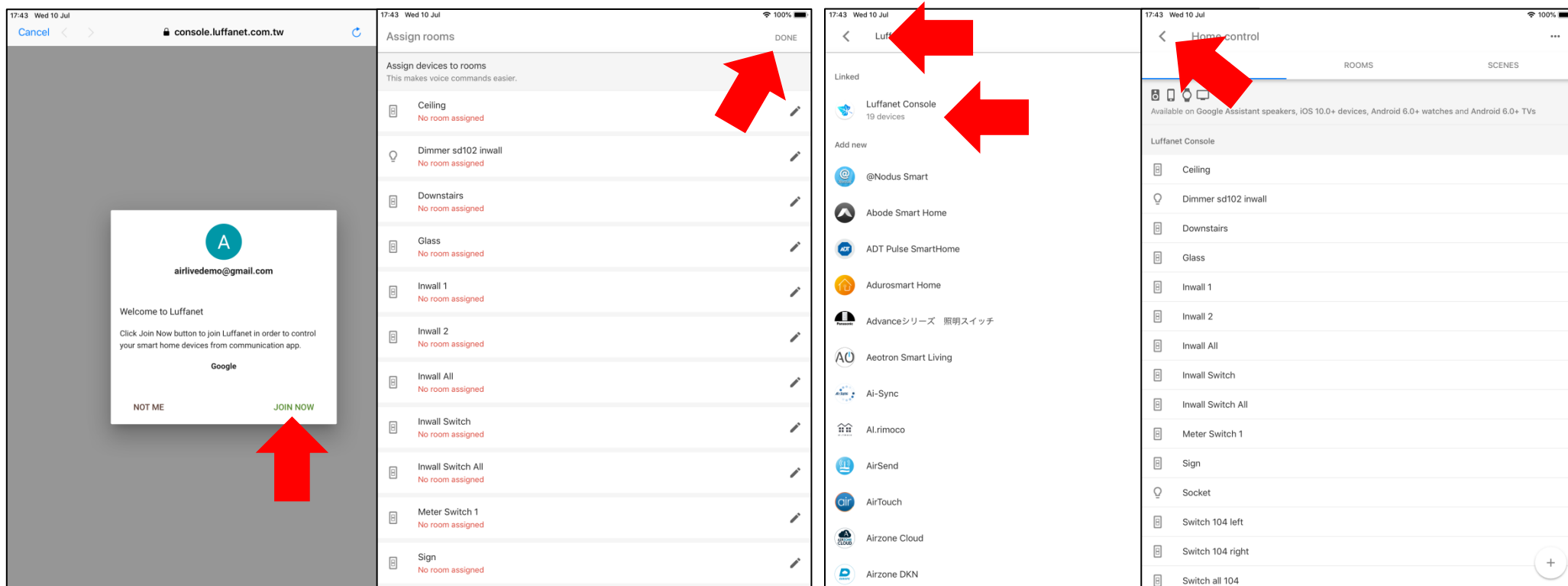

Your devices will now be shown in Google Home and you can use them, they can be operated by the App or via Voice Control by saying Ok Google turn on/off (name of your light) or OK Google dimmer 48%.

When you like to add additional devices to the Gateway on a later time and also see them in the Google app please say "OK Google Sync Devices".

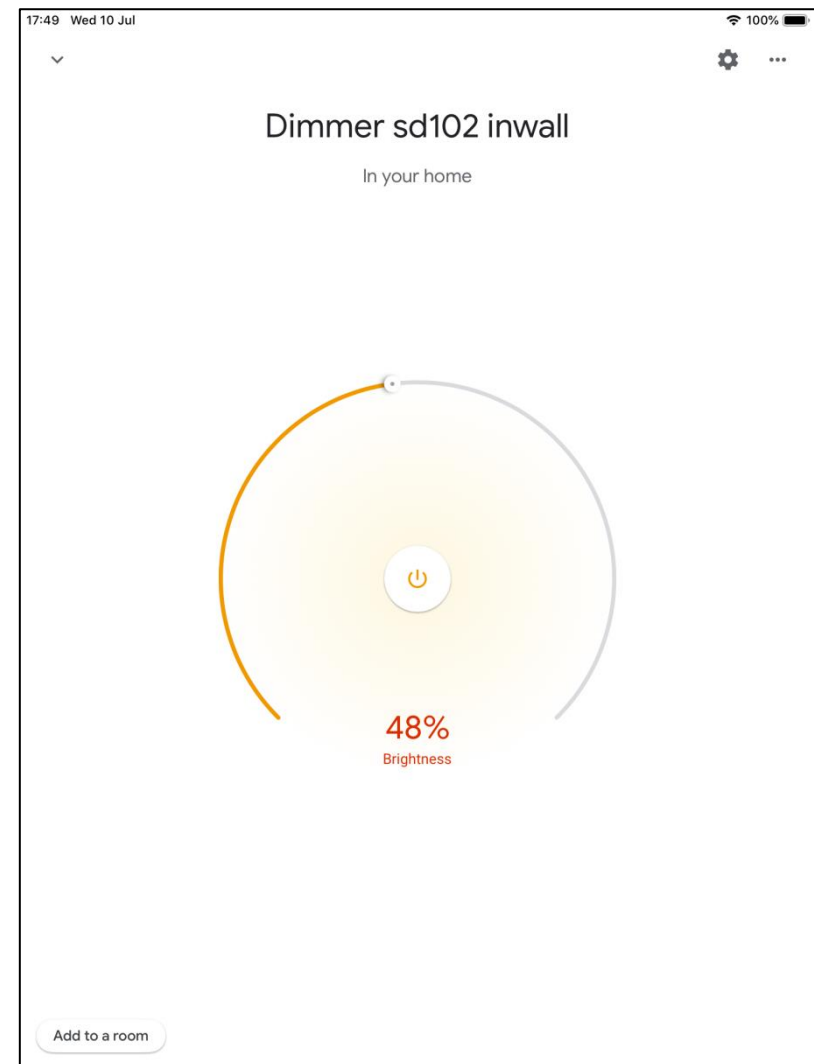
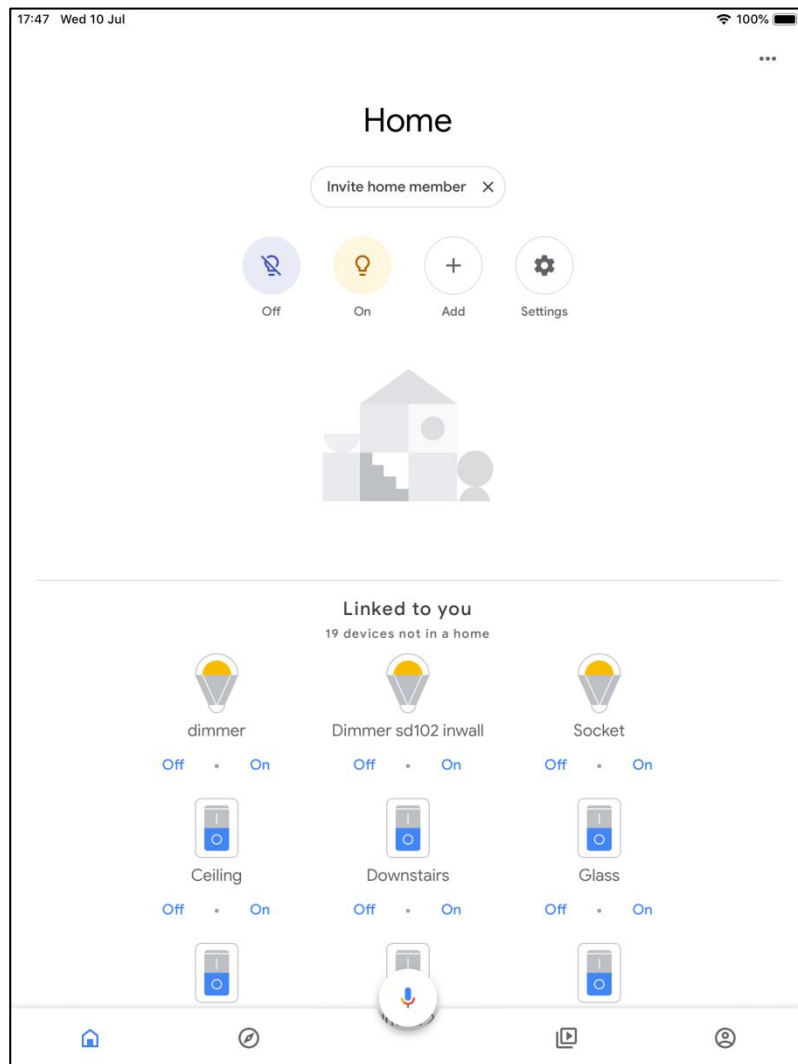

To Unlink your devices Go back to the list page and Click on Luffa Console and select Unlink

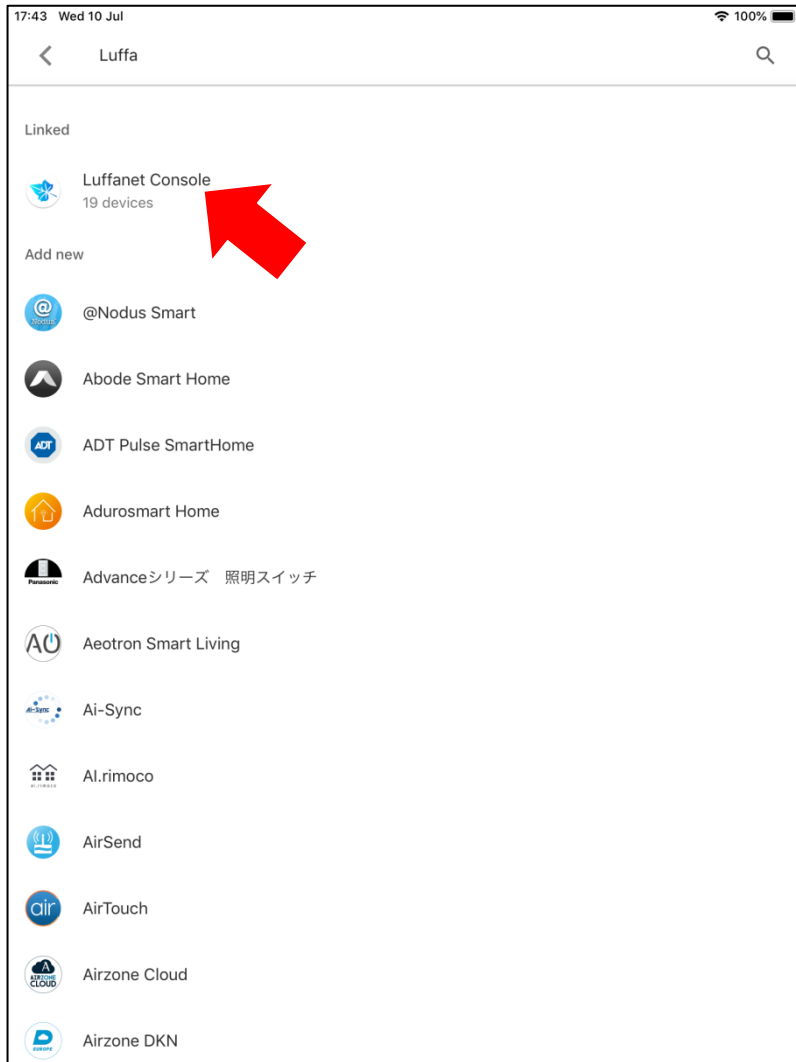

Points to note:

Make sure your Gateway and all the devices are working.

Make sure your Google Home/Assistant is working.